

# AquaSense

## Wireless sensors

With Water Linked Aqua Sense you can operate a fully featured sensor population in tough environments, without the cables.



# Aqua Sense

## Sensor data anywhere

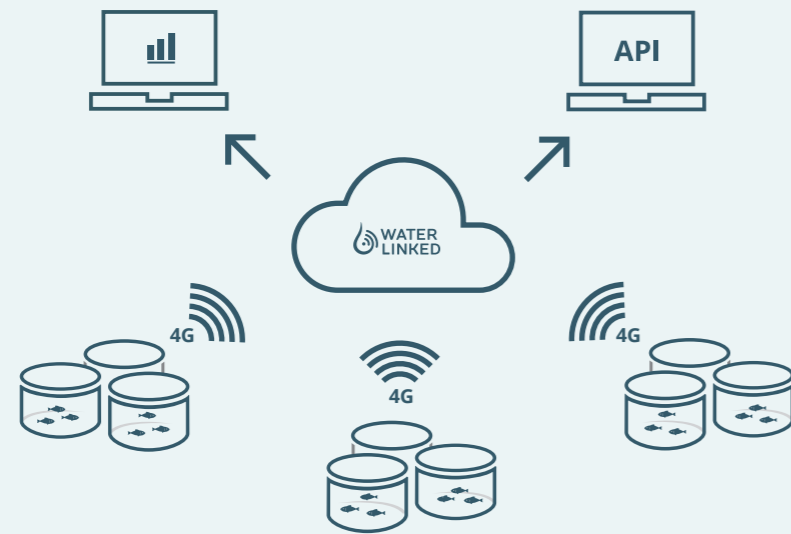

**All sensors will in addition report:**

- Tilt angle
- Depth
- Temperature

### Available sensors



**Oxygen**



**Salinity**

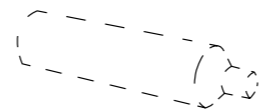

**Tension**

View the sensor at AquaNor

### Unlimited number of sensors

You can deploy any number of sensors at your site without worrying about cabling. The sensors can easily be moved from one cage to another without the traditional re-routing of cables.

### Easy Deployment

The sensors are easily deployed with no need for expensive expert assistance. Typical deployment options are hanging from a rope or mounted to a fixed structure using cable ties.

### Battery powered

All the sensors use internal Lithium batteries to enable long term operation (18+ months). Charging is done using a cellphone charger. Battery status is sent from the sensor to your dashboard.

### Unique sensor position data

All our sensors include the world leading Underwater GPS technology. This enables the exact position of the sensors to be displayed in the web interface.

### High quality water sensors

By utilizing water sensors from world leading Aanderaa by Xylem, high quality measurements are secured.

### Sensor data online

Use a web-based interface or integrate with your existing monitoring system. This enables easy access to your sensor data from anywhere.

### Expandability Options

Wherever an Aqua Sense system is deployed, you can easily expand the functionality into underwater positioning of feeding cameras, net cleaners, ROVs, divers and any other underwater device - without adding new infrastructure to the site.

### Unique tension sensor

The Aqua Sense Tension Sensor is a tool to monitor the tension and load that your moorings are exposed to. Save money and reduce risk by taking educated decisions on whether to replace a shackle or other parts of the mooring system.

# Get a quote!

Contact us with your plans and requirements for sensors in your operation and let us together find the optimal solution.



Trondheim, Norway (+47) 90115038  
waterlinked.com sales@waterlinked.com